

## SPDT 8A 60V Solid State Relay

### Features

Break before make pole switching  
Optical isolation 500V min  
Fast switching speed, less than 1ms  
Hermetic power package.  
Low on resistance  
High current surge rating

### Maximum ratings

120V per out[put] 0.1 sec max  
35 Amp starting surge,  $t_c = 1.5\text{ms}$   
Operating temperature  $-40\text{C}$  to  $+90\text{C}$   
Storage temperature  $-40\text{C}$  to  $+125\text{C}$   
Shock TBD  
Vibration TBD  
Ambient Air Pressure 1.2 Bar to 180mB

### Specifications

On Resistance 0.08 ohms max,  $I_o = 8\text{A}$ ,  $T_c = 90\text{C}$   
Leakage current 10ua max at 70V, each output  
Switching speed pole A to pole B 1ms max ( including delay )  
Control input = 0 to 10V output "A on"  
Control input = 12 to 20V output "B on"  
Control supply = 10V (TBD)  
Control supply current 75 ma max. ( TBD)

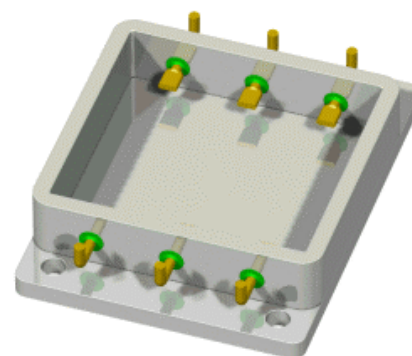
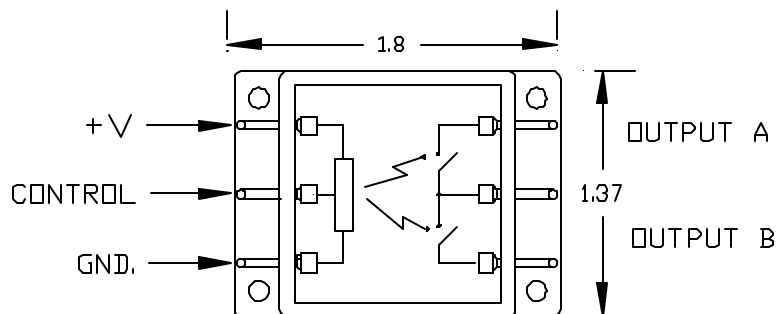

Base thickness 0.100"  
Overall height 0.395"

# Preliminary